



**2/479 Henry Lawson Drive Milperra NSW**

Be part of this prominent and thriving retail precinct, Flower Power Garden Centre, Milperra.

Flower Power's flagship store is a state-of-the-art garden centre and the first of its kind in Australia, offering a unique experience inspired by world-class garden centres overseas.

This is the first all-weather Garden Centre in Australia with ample parking, fantastic customer facilities, join other well know retailers like, Frankies Café, Petstock, and Wholefarms, in Sydney's largest and most customer focused nursery complex.

The retail space is 310m2 with a wide frontage to the car park, plus huge pedestrian traffic and exposure. Offering attractive rental terms for the right operator, don't miss out on this opportunity!

[For full version visit the website](https://www.nickolasproperties.com.au)

**Type** : Retail  
**Building Size** : 309 sqm  
**View** : <https://www.nickolasproperties.com.au/lease/nsw/canterburybankstown/milperra/commercial/retail/7993525>



**Bill Nickolas**  
8354 1444

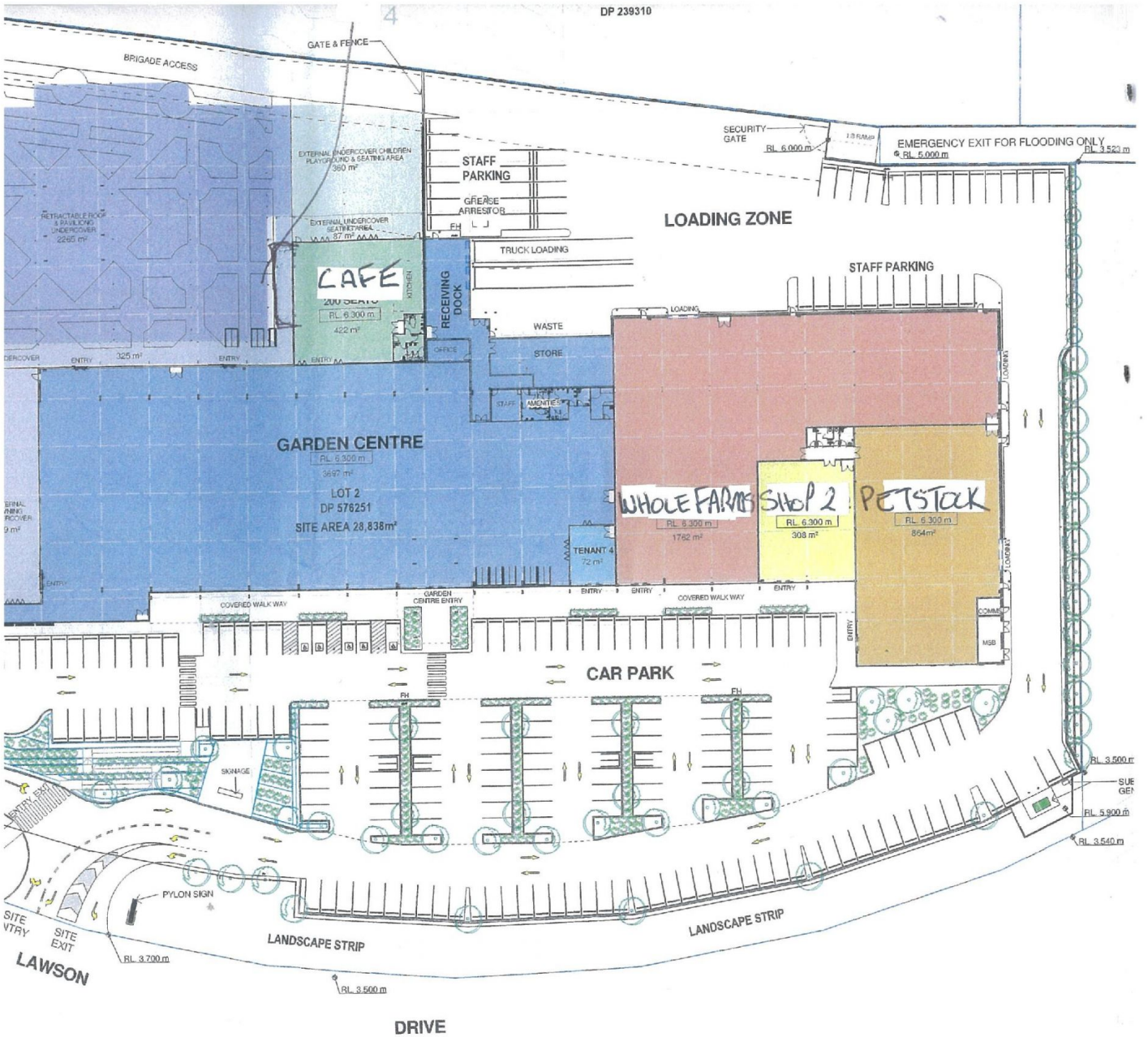

NETS PARADE